

DESPIECE DE LA HERRAMIENTA

Usted encontrará con un círculo las piezas de desgaste recomendadas para mantener en stock.

RASA-12

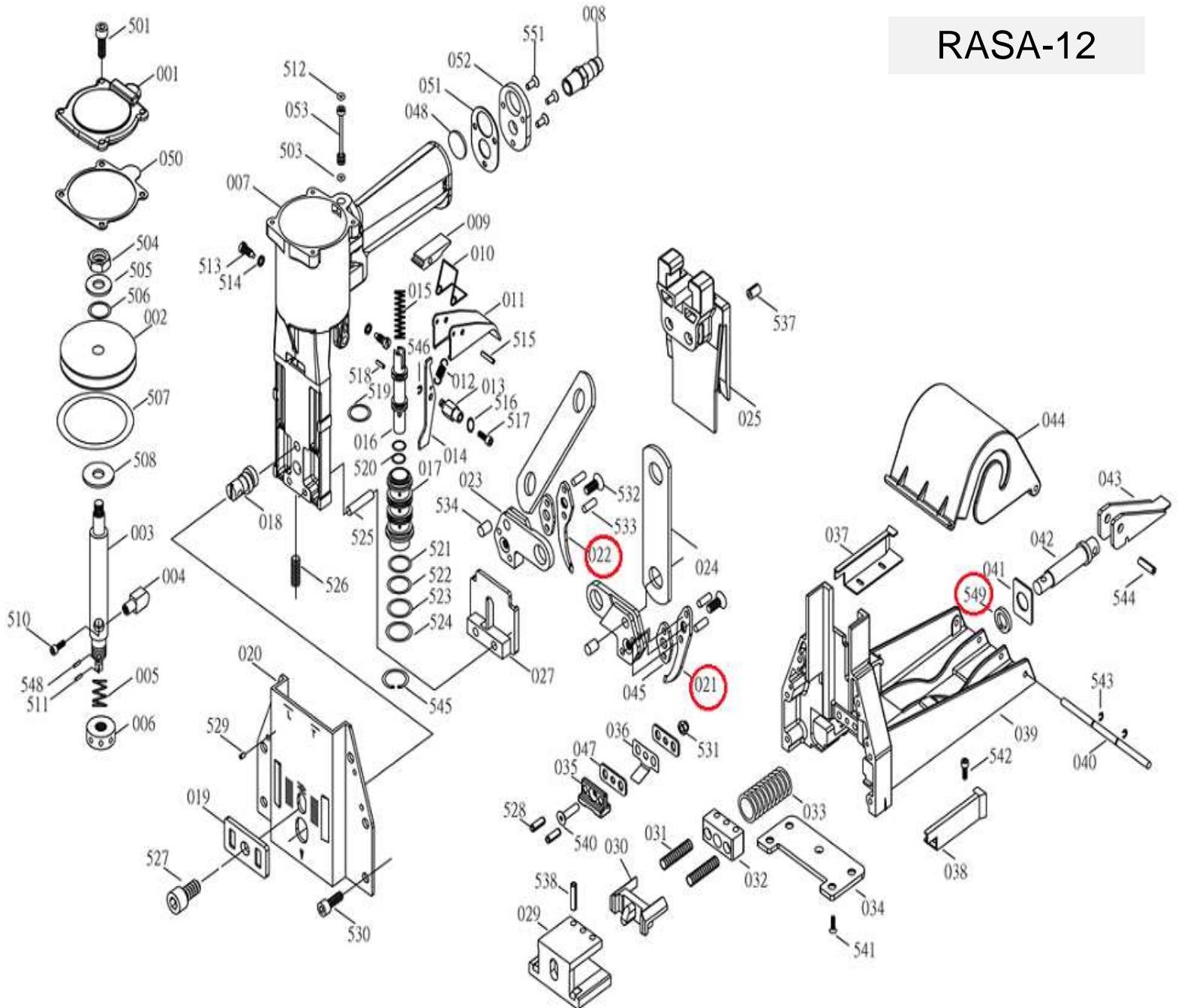

021 Cuchilla derecha

022 Cuchilla izquierda

549 Arandela

KIT: Una cuchilla derecha (021), cuchilla izquierda (022) y arandela (549)

Propiedad de: Implementos Neumáticos SA de CV
Prohibida la reproducción parcial o total

LISTA DE PARTES
MODELO: RASA-12-15

CONFIDENCIAL

Item	Part No.	Description	Q'ty	Specification	P. Lista
001	A01200113	CAP	1	NO MARK	396.19
002	A02800201	PISTON	1		280.83
003	A02800301	PISTON ROD	1		573.31
004	A00100401	BLOCK	1		131.68
005	A00100501	SPRING	1		19.13
006	A00100601	COLLAR	1		87.40
007	ADCSN-P31	BODY UNIT	1		5,017.65
008	A00100802	ESPIGA	1		62.92
009	A00100902	BLOCK	1		53.60
010	A00101001	SPRING	1		19.13
011	A00101101	TRIGGER	1		66.42
012	A00101201	SPRING	1		19.13
013	A00101301	ROD	1		52.44
014	A00101402	TRIGGER'S CONTROL	1		43.11
015	A00101501	SPRING	1		19.13
016	A00101601	VALVE	1		206.25
017	A00101702	TUBE	1		291.32
018	A00101801	ADJUSTING ROD	1		327.44
019	A00101901	ADJUSTING PLATE	1		48.94
020	A01102503	FRONT PLATE	1	22	273.84
021	A07600101	TEETH	1	S-12 series	191.10
022	A07600101	TEETH	1	S-12 series	191.10
023	A00102301	TEETH SEAT	2		355.41
024	A00102401	PLATE	2		43.11
025	A02202802	DRIVER	1		1,771.21
027	A02200202	DRIVER GUIDE UNIT	1	S series	475.43
029	A02200601	ANVIL	1	S series	494.07
030	A02200702	PUSHER	1	S series	428.82
031	A02201101	SPRING	2		48.94
032	A02200501	ANVIL CAP	1		261.02
033	A02201201	SPRING	1		74.58
034	A02200901	PLATE	1		214.41
035	A02202901	TOP GUIDE	1		291.32
036	A02201803	LEAF SPRING	1		37.29
037	A07600401	RIGHT COIL GUIDE	1	S-12 series	66.42
038	A07600501	LEFT COIL GUIDE	1	S-12 series	66.42
039	A02200110	MAGAZINE SEAT	1		1,538.16
040	A02201301	SHAFT	1		62.92
041	A02201903	WASHER	1		37.29
042	A02200801	SHAFT	1		177.12
043	A02201001	LEVER	1		111.87
044	A02201401	COVER	1		130.51
045	A02300801	PLATE	2		50.11
047	A02202402	WASHER	2		46.61
048	BA11401	SILENCER	1		58.26
050	A01202201	WASHER	1		116.53
051	A00106001	WASHER	1		87.40

Item	Part No.	Description	Q'ty	Specification	P. Lista
052	A00105801	COVER	1		69.92
053	A01202301	SHAFT	1		116.53
501	BAC0604142	HEX.SOC.HD.BOLT	4	M4 x 0.7-14	19.13
503	BAB017029	O-RING	1	ψ1.78 x ψ53.7	19.13
504	BAD02061	HEX.NUT	1	M6 x 1	19.13
505	BAE06094	WASHER	1	1/4" x 5/8" x 1T	19.13
506	BAB017076	O-RING	1	ψ1.78 x ψ7.65	19.13
507	BAB057476	O-RING	1	ψ5.7 x ψ47.6	19.13
508	A00104101	WASHER	1	ψ8 x ψ23 x 1.6T	19.13
509	BAE01042	SPRING WASHER	1	M4	19.13
510	BAC0404102	HEX.SOC.HD.BOLT	1	M4 x 0.7-6	19.13
511	BAA025014	SPRING PIN	1	ψ2.5-14	19.13
513	A00104401	TRIGGER SCREW	2	M4 x 0.7-7	19.13
514	BAE01042	SPRING WASHER	2	M4	19.13
515	BAA030020	SPRING PIN	1	ψ3-20	19.13
516	BAE02042	OUTSIDE TEETH WASHER	1	M4	19.13
517	BAC0404102	HEX.SOC.HD.BOLT	1	M4 x 0.7-10	19.13
518	BAA030010	SPRING PIN	1	ψ3-10	19.13
519	BAB017124	O-RING	1	ψ1.78 x ψ12.42	19.13
520	BAB017076	O-RING	2	ψ1.78 x ψ7.65	19.13
521	BAB016145	O-RING	1	ψ1.6 x ψ14.5	19.13
522	BAB016150	O-RING	1	ψ1.6 x ψ15	19.13
523	BAB016155	O-RING	1	ψ1.6 x ψ15.5	19.13
524	BAB016160	O-RING	1	ψ1.6 x ψ16	19.13
525	A00104702	ROD	2	ψ4.9-17.5	19.13
526	BAC0306142	HEX.SOC.HDLESS. BOLT	1	M6 x 1-14	19.13
527	BAC0608162	HEX.SOC.HD.BOLT	1	M8 x 1.25-16	19.13
528	BAA050014	SPRING WASHER	2	M8	19.13
529	BAA030010	SPRING PIN	4	ψ3-10	19.13
530	BAC0605142	HEX.SOC.HD.BOLT	6	M5 x 0.8-14	19.13
531	BAD01051	LOCK NUT	1	M5 x 0.8	19.13
532	BAC0205142	HEX.SOC.FLAT COUNTER SCREW	2	M5 x 0.8-14 S series	19.13
533	A00104501	PIN	4	ψ3.98-13	19.13
534	A00104602	PIN	2	ψ6.05-8	20.97
537	BAA060016-R	SPRING PIN	2	ψ6-16	31.46
538	BAA040022	SPRING PIN	3	ψ4-22	19.13
540	BAC0205202	HEX.SOC.HD.BOLT	1	M5 x 0.8-12	19.13
541	BAC0205082	HEX.SOC.FLAT COUNTER	4	M5 x 0.8-8	19.13
542	BAC0703063	ROUND HD.SCREW	4	M3 x 0.5-6	19.13
543	BAF10252	E-RING	2	ψ2.5	19.13
544	BAA040020	SPRING PIN	1	ψ4-20	19.13
545	BAF22002	C-RING	1	ψ20	19.13
546	BAF10252	E-RING	1	ψ2.5	19.13
548	A00104901	PLASTIC PIN	1		19.13
549	BAE03102	WAVE WASHER	1	ψ10	19.13
551	BAC0204122	HEX.SOC.FLAT COUNTER SCREW	1	M4 x 0.7-12	19.13

*Precios en moneda nacional